

# Frame

## Table of Contents

Exploded View .....	14-2
Seats .....	14-5
Seat Removal (ZX750N) .....	14-5
Seat Installation (ZX750N) .....	14-5
Rear Seat Removal (ZX750P) .....	14-5
Rear Seat Installation (ZX750P) .....	14-5
Front Seat Removal (ZX750P) .....	14-6
Front Seat Installation (ZX750P) .....	14-6
Seat Cover (ZX750N) .....	14-7
Seat Cover Removal .....	14-7
Side Covers (ZX750P) .....	14-8
Side Cover Removal .....	14-8
Side Cover Installation .....	14-8
Fairings .....	14-9
Inner Fairing Removal .....	14-9
Inner Fairing Installation .....	14-9
Upper Fairing Removal .....	14-9
Lower Fairing Removal .....	14-9
Fenders .....	14-10
Front Fender Removal .....	14-10
Rear Fender Removal .....	14-10
Rear Fender Installation .....	14-10
Battery Case .....	14-11
Battery Case Removal .....	14-11
Rear Frame .....	14-12
Rear Frame Removal .....	14-12
Rear Frame Installation .....	14-12

## 14-2 FRAME

### Exploded View

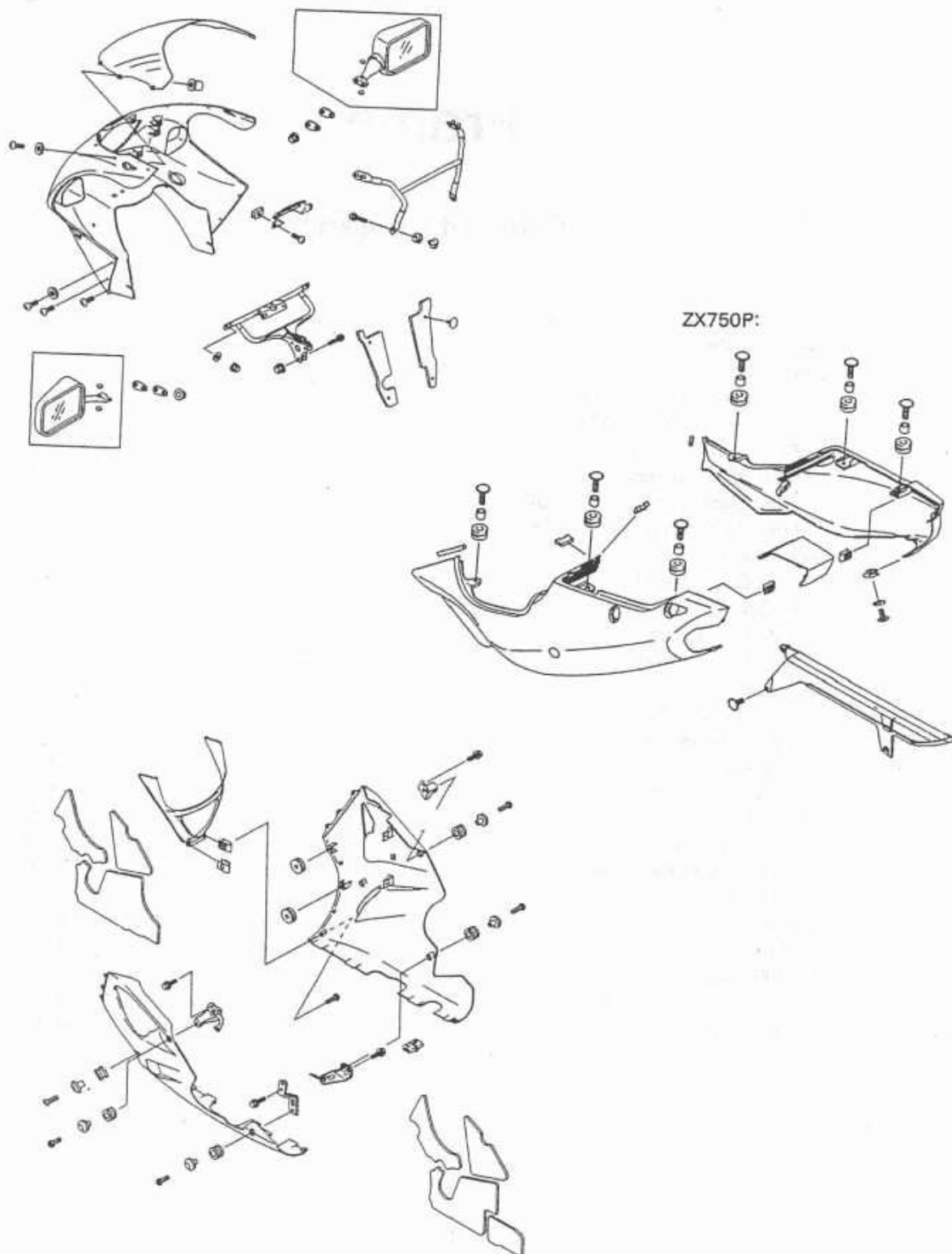

L: Apply a non-permanent locking agent.  
O: Apply oil.

T1: 34 N-m (3.5 kg-m, 25 ft-lb)  
T2: 44 N-m (4.5 kg-m, 33 ft-lb)  
T3: 49 N-m (5.0 kg-m, 36 ft-lb)  
T4: 59 N-m (6.0 kg-m, 43 ft-lb)

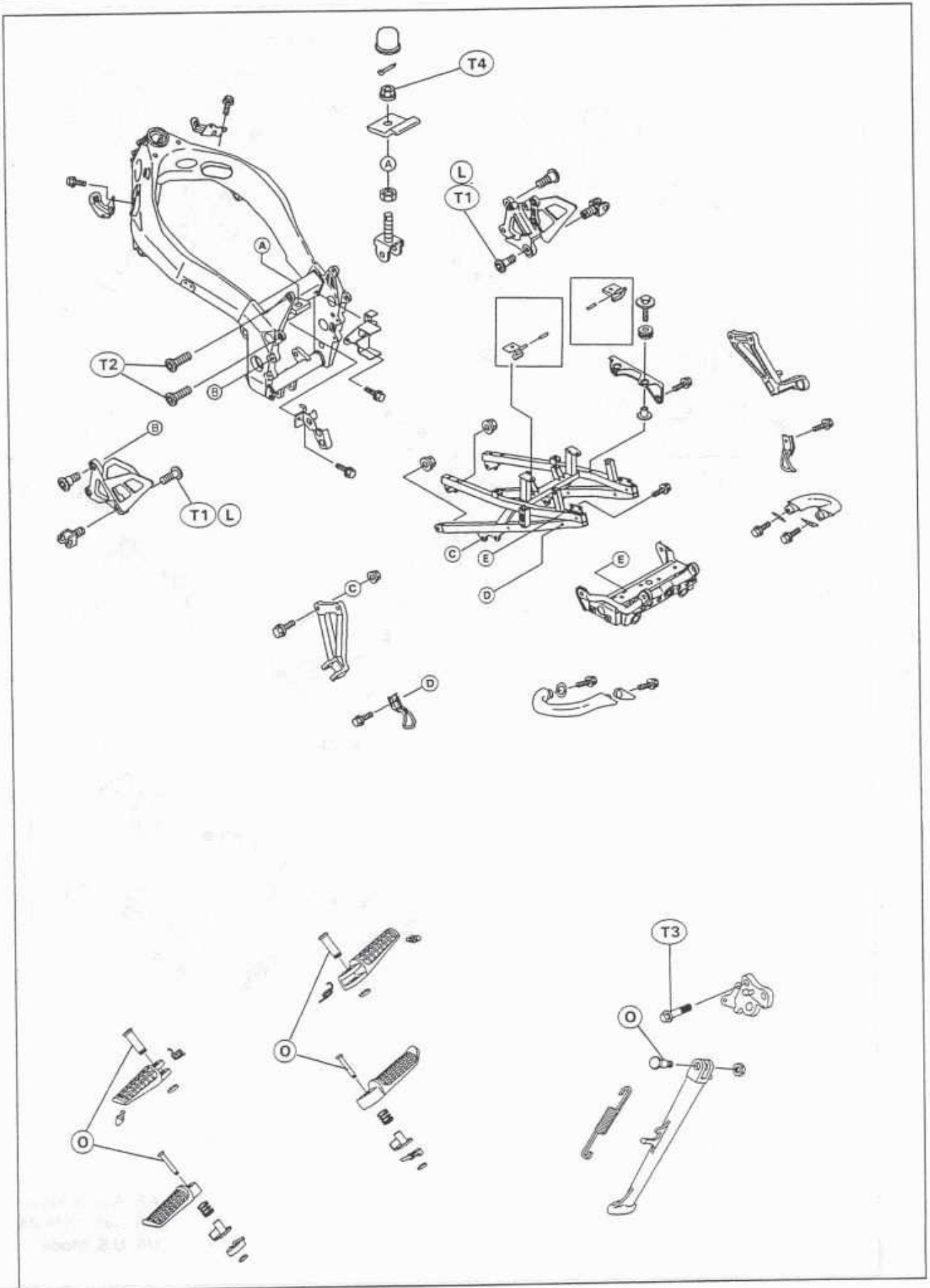

# 14-4 FRAME

ZX750P:

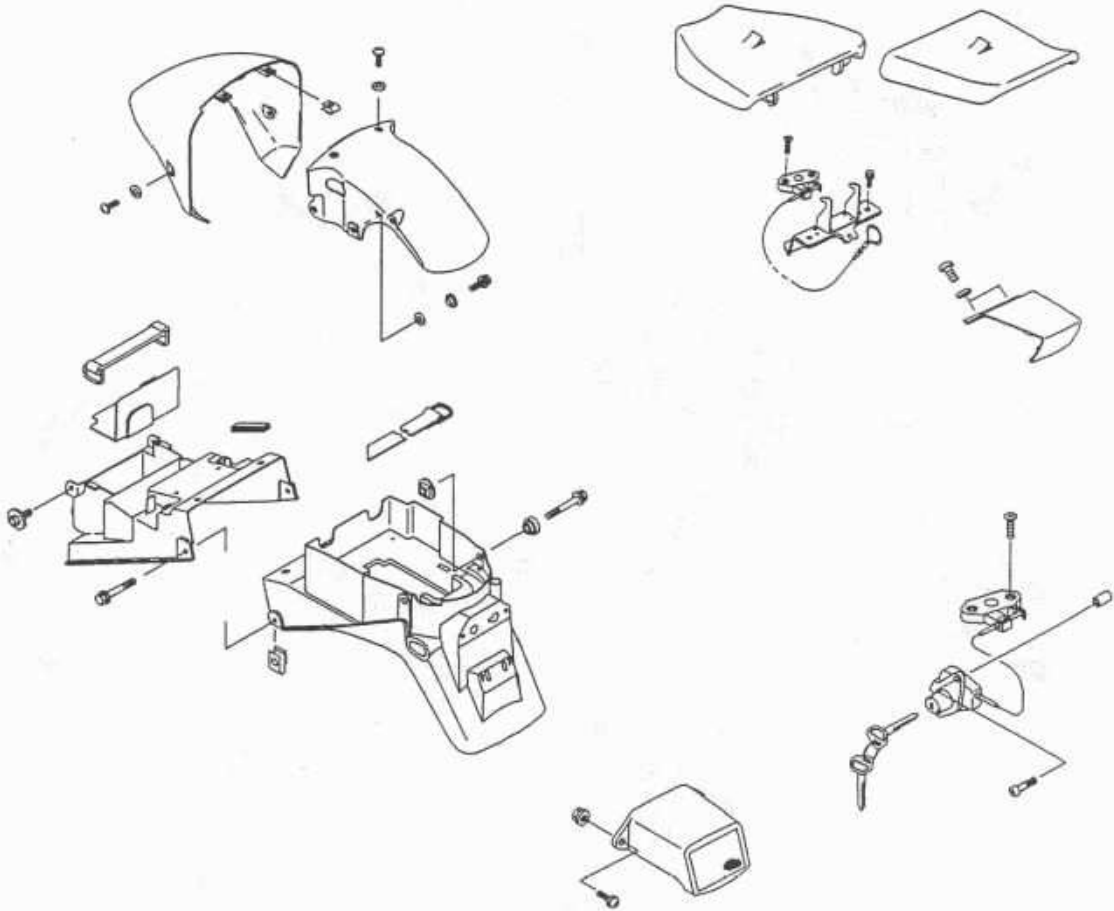

(AR,CN,US)

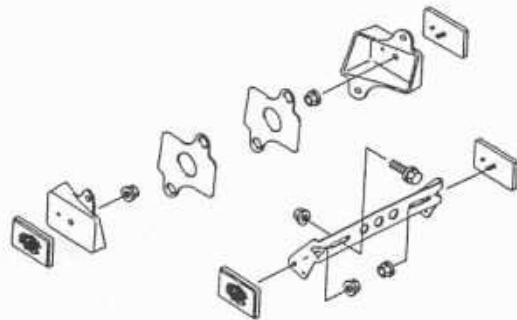

AR: Austria Model  
CN: Canada Model  
US: U.S. Model

**Seats**

**Seat Removal (ZX750N)**

- Insert the ignition switch key [A] into the seat lock, turning the key counterclockwise, pulling up on the rear of the seat [B].
- Remove the key from the seat lock.

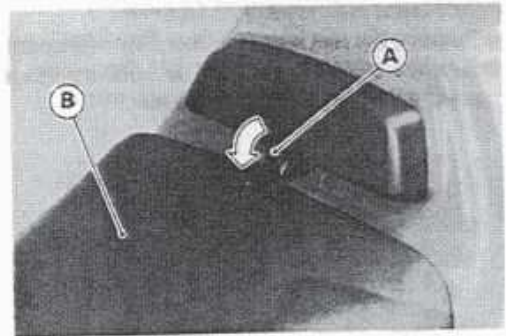

- Remove the seat by pulling up on the rear of the seat and pulling it backward.

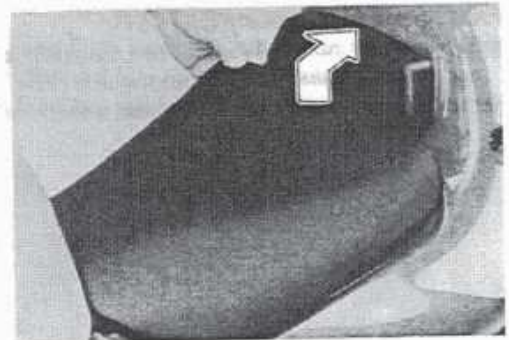

**Seat Installation (ZX750N)**

- Slip the seat hook [A] under the brace [B] on the fuel tank bracket, and insert the seat pin [C] into the latch hole [D].
- Push down the rear part of the seat until the lock clicks.

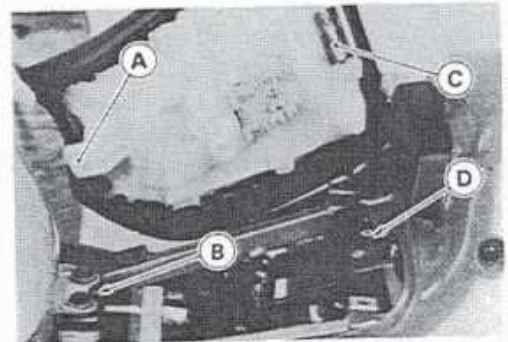

**Rear Seat Removal (ZX750P)**

- Insert the ignition switch key [A] into the seat lock, turning the key counterclockwise, pulling up on the rear of the seat [B], and pulling it forward.

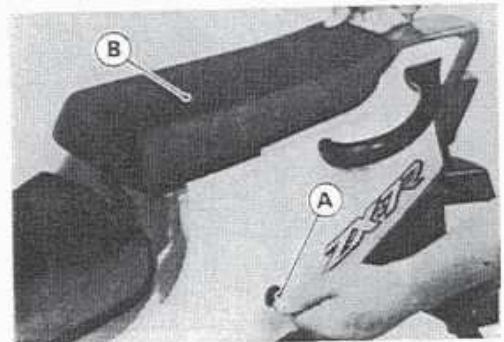

**Rear Seat Installation (ZX750P)**

- Slip the rear loop [A] under the hooks [B] on the hook bracket.
- Insert the seat pin [C] into the latch hole [D].
- Push down the rear part of the seat until the lock clicks.

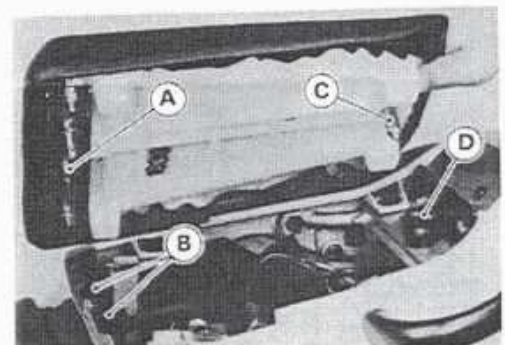

## 14-6 FRAME

### *Front Seat Removal (ZX750P)*

- Remove the rear seat (see Rear Seat Removal).
- Remove the front seat [A] by pulling the seat latch [B] and then pulling the seat up and to the rear.

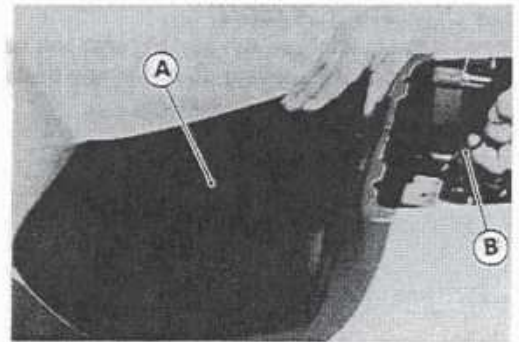

### *Front Seat Installation (ZX750P)*

- Slip the seat hook [A] under the brace [B] on the fuel tank bracket, and insert the seat pin [C] into the latch hole [D].
- Push down the rear part of the seat until the lock clicks.

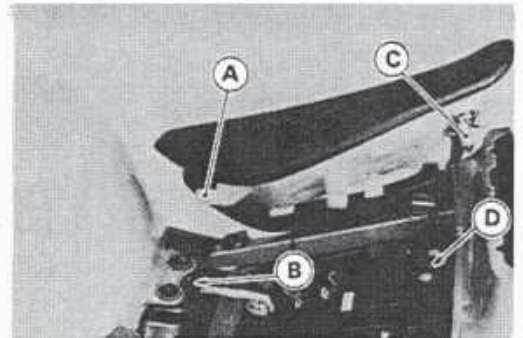

**Seat Cover (ZX750N)**

**Seat Cover Removal**

- Remove:
  - Seat (see Seat Removal)
  - Screws [A]
  - Screws and Lock [B]
  - Seat Cover [C]

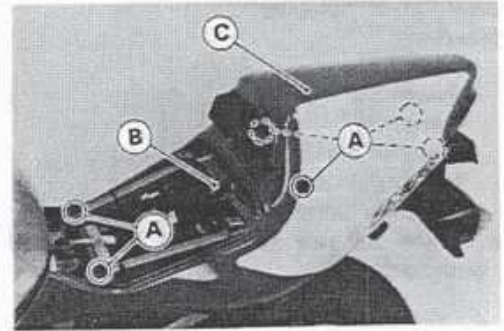

## 14-8 FRAME

### Side Covers (ZX750P)

#### Side Cover Removal

- Remove:
  - Seats
  - Screws [A]
  - Clamps [B]
  - Grab Rail Bracket Bolts [C]
  - Screws and Lock [D]
  - Tail/Brake Lights Lead Connector
- Remove the side cover with the tail/brake lights and grab rails backward.

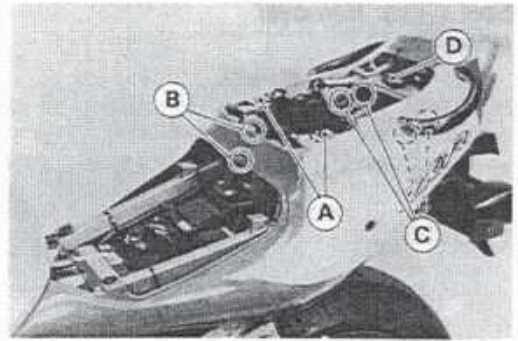

- Remove:
  - Upper Side Screws [A]
  - Under Side Screw [B]

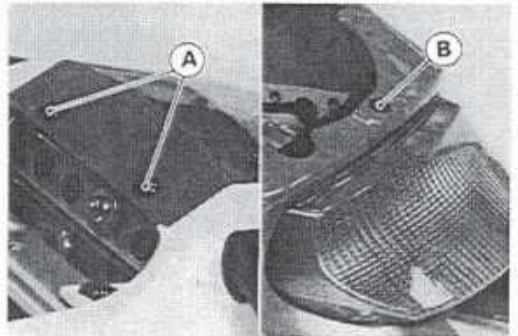

- Pull the front part of the center cover [A] upward and backward to clear the stoppers [B].

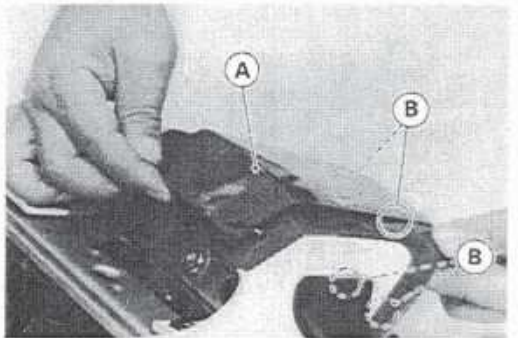

- Remove:
  - Grab Rail Bolts [A]
  - Grab Rail [B]
  - Side Cover [C]

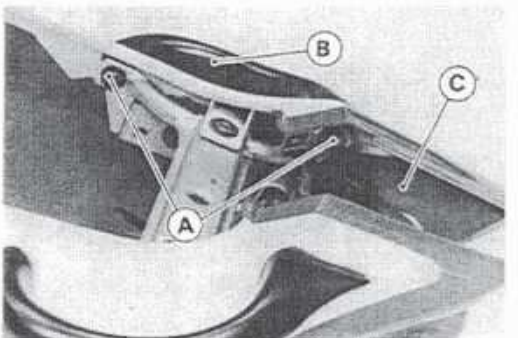

#### Side Cover Installation

- Fit the stoppers [A] of the center cover to the side covers and then fit the projections [B] into the slits [C] in the covers.

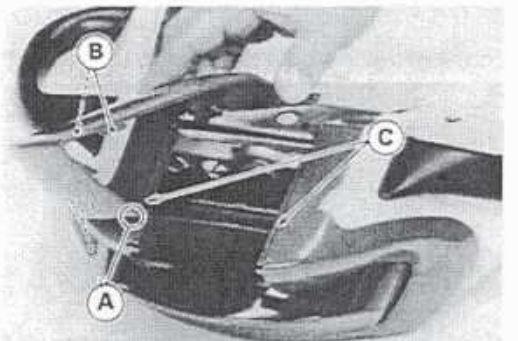



## Fairings

### Inner Fairing Removal

- Remove the screw [A], and pull the front part of the inner fairing [B] upward to clear the stopper
- Remove the inner fairing.
- Remove the other inner fairing in the same manner.

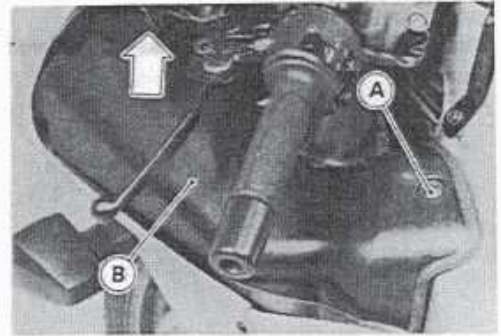

### Inner Fairing Installation

- Fit the projection [A] on the inner fairing into the hole [B] in the air intake duct [C].
- Install the screws.

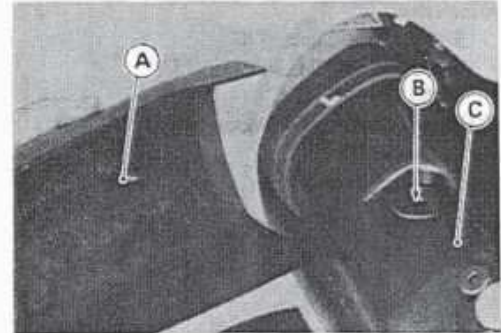

### Upper Fairing Removal

- Remove:
  - Inner Fairing
  - Rear View Mirrors [A]
  - Bracket Nuts [B]
  - Screws [C]
  - Headlight Connector
  - Turn Signal Light Lead Connectors
  - City Light Connector (other than US, Canada and Australia)
- Remove the upper fairing.

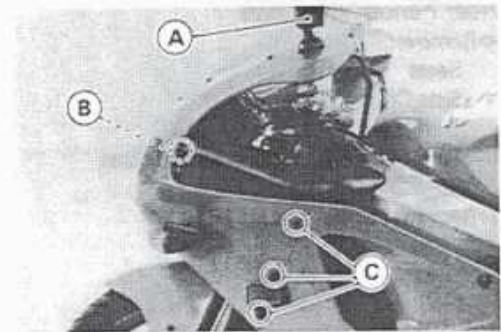

### Lower Fairing Removal

- Remove:
  - Screws [A] [B]
  - Allen Bolts [C]
  - Clamp [D]
- Remove the lower fairing.
- Remove the other lower fairing in the same manner.

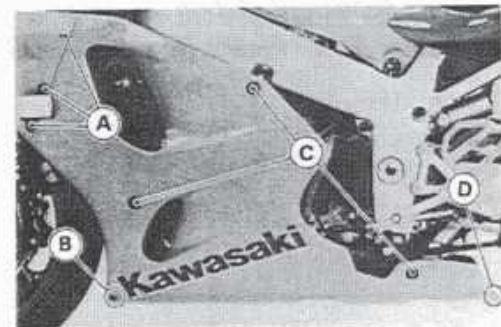

### NOTE

- When removing the left and right lower fairings at the same time, do not remove the screws [B] (both sides) and clamp [D].

## 14-10 FRAME

### Fenders

#### Front Fender Removal

- Remove the screws [A] and take off the front fender front [B].

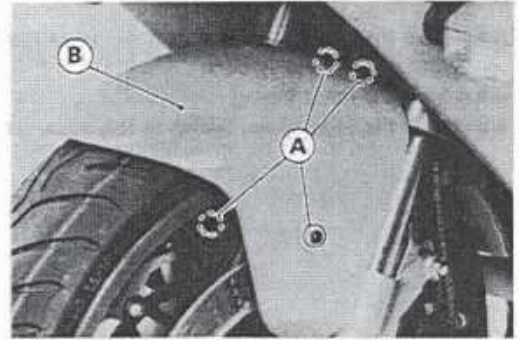

- Remove:
  - Brake Hose Clamps [A]
  - Speedometer Cable Clamp [B]
  - Bolts [C]
- Remove the front fender rear [D].

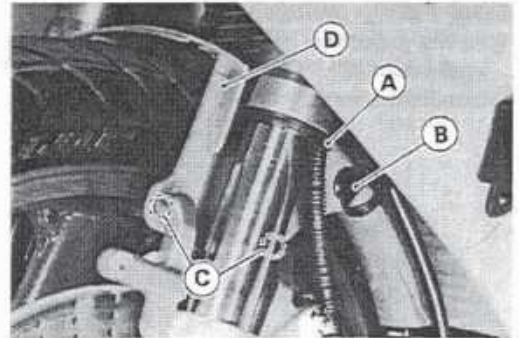

#### Rear Fender Removal

- Remove:
  - Seats
  - Side Covers
  - Turn Signal Relay
  - Turn Signal Light Lead Connectors
  - Bolts [A]
- Remove the rear fender [B].

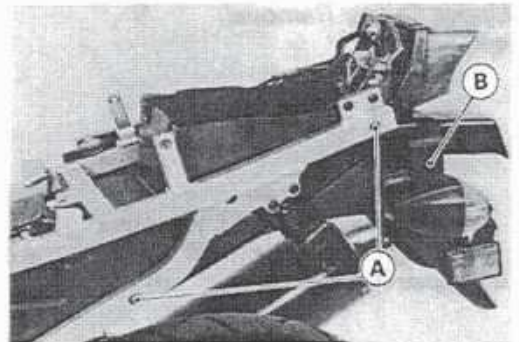

#### Rear Fender Installation

- Fasten the ground terminal [A] with the mounting bolt as shown.

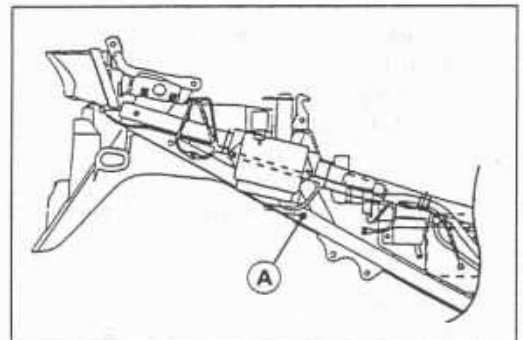

## Battery Case

### *Battery Case Removal*

● Remove:

- Seats
- Side Covers
- Rear Fender
- Junction Box
- Starter Relay and Main Fuse
- Turn Signal Relay
- Fuel Pump Relay
- Battery
- Rear Brake Reservoir Mounting Bolt
- Mounting Bolts [A]
- Battery Case [B]

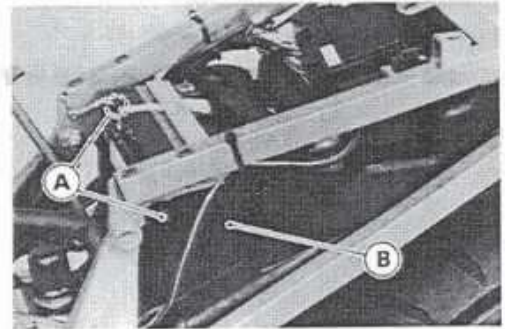

## 14-12 FRAME

### Rear Frame

#### *Rear Frame Removal*

- Remove:
  - Rear Fender (see Rear Fender Removal)
  - Battery Case (see Battery Case Removal)
  - Frame Bolts and Nuts [A]

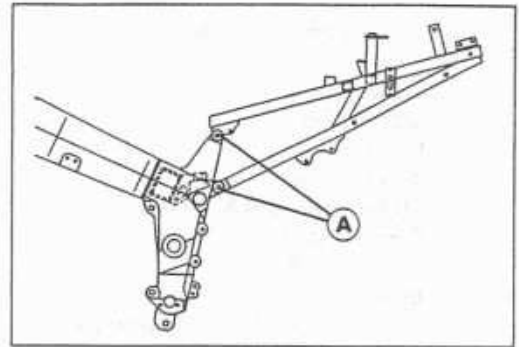

#### *Rear Frame Installation*

- Tighten the frame bolts and nuts.  
**Torque – Rear Frame Bolts and Nuts: 44 N-m (4.5 kg-m, 33 ft-lb)**