

# Engine Top End

## Table of Contents

Exploded View .....4-2  
Specifications .....4-4  
Special Tools .....4-6  
Sealant.....4-7

# 4-2 ENGINE TOP END

## Exploded View

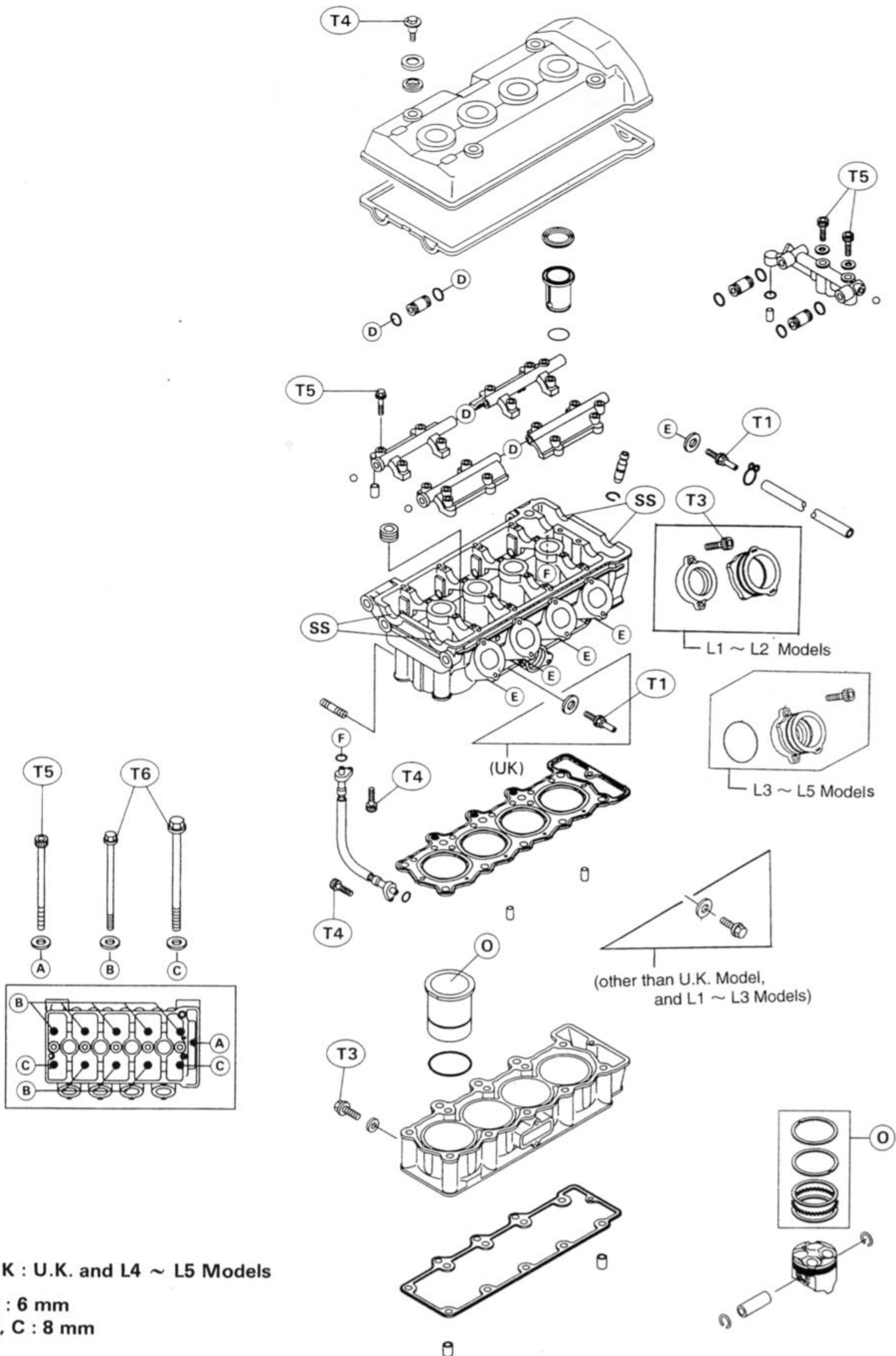

UK : U.K. and L4 ~ L5 Models

A : 6 mm

B, C : 8 mm

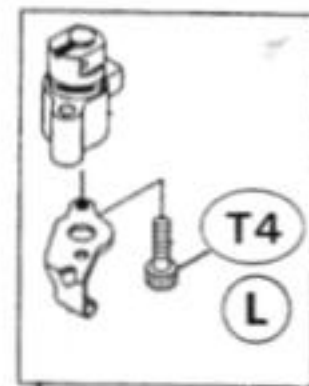
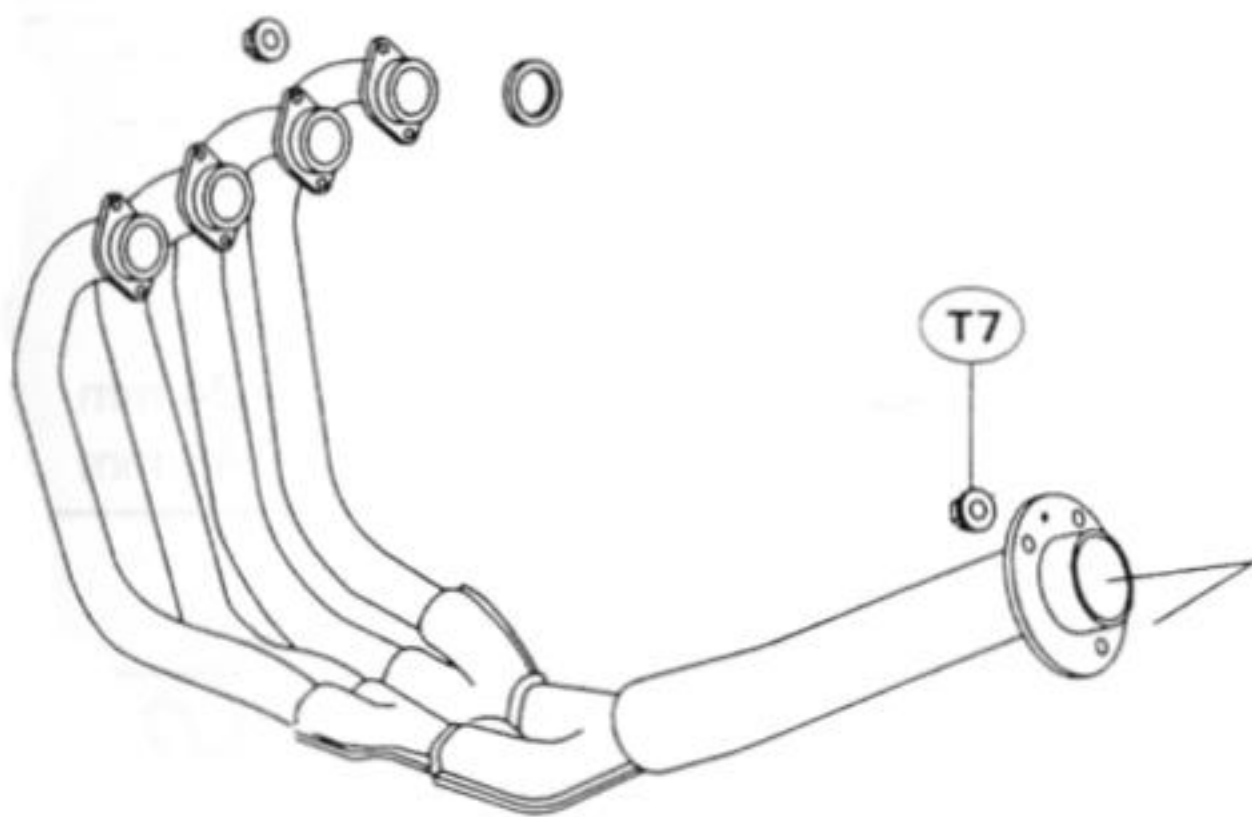
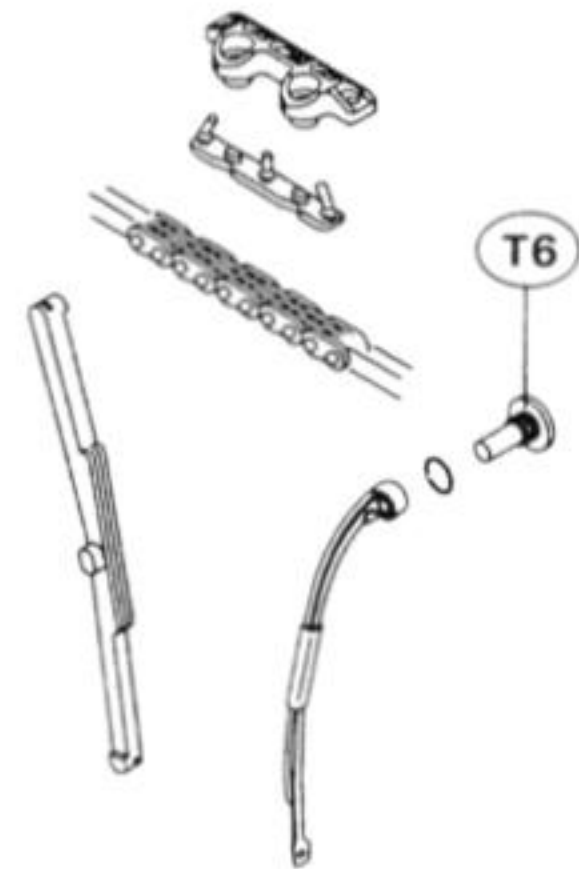
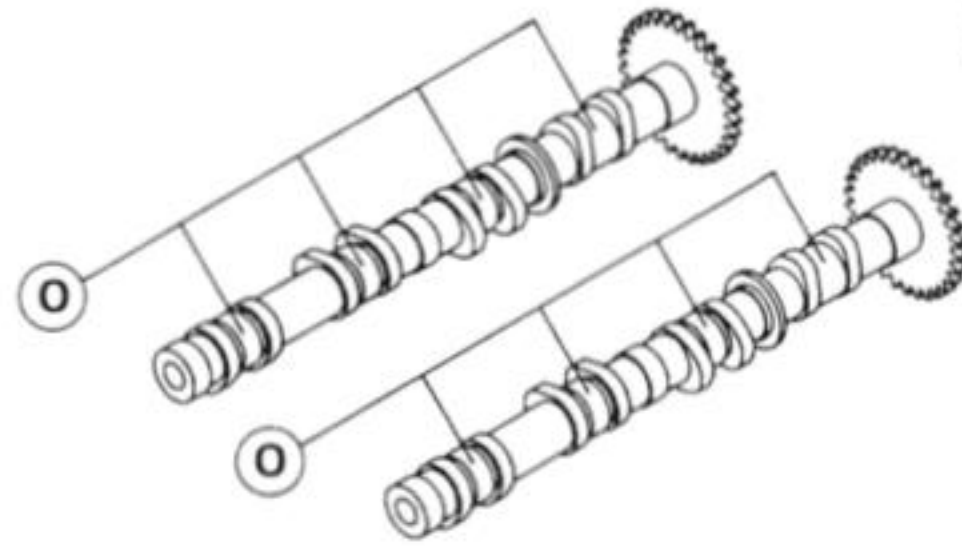
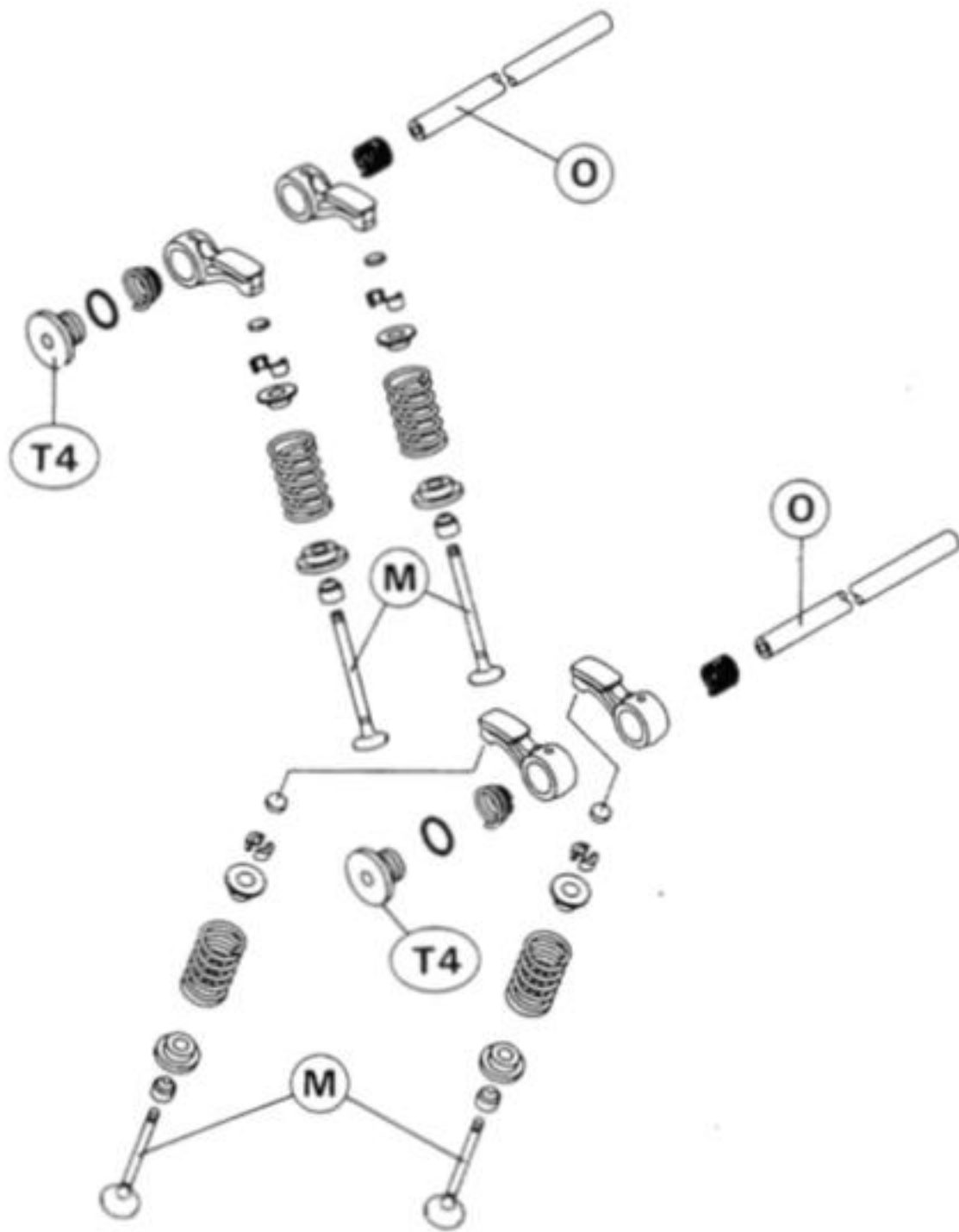

L3 ~ L5 Models

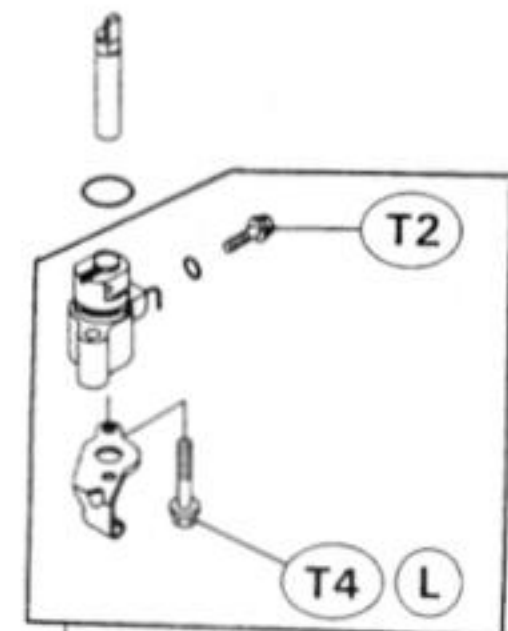

L1 ~ L2 Models

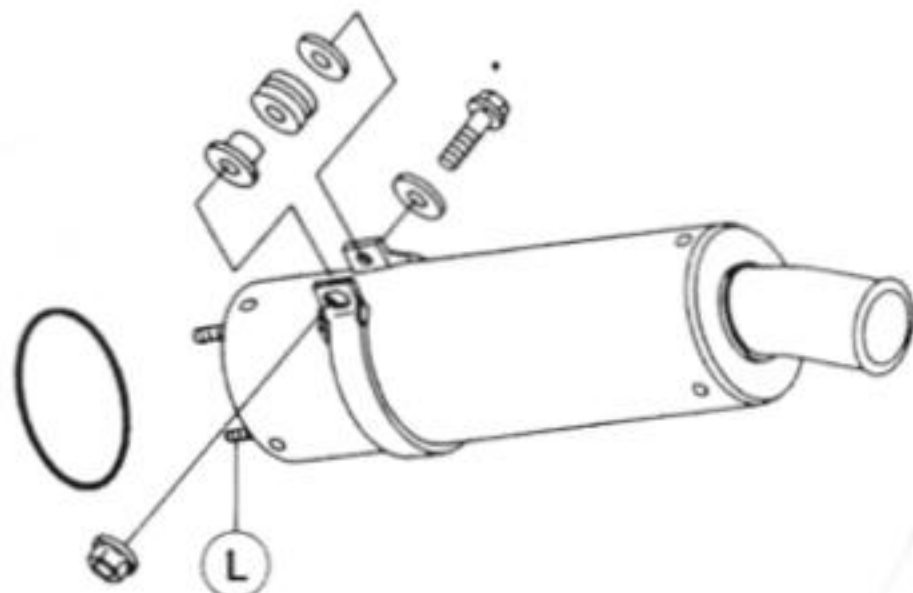

- T1 : 4.9 N-m (0.5 kg-m, 43 in-lb)
- T2 : 5.9 N-m (0.6 kg-m, 52 in-lb)
- T3 : 8.8 N-m (0.9 kg-m, 78 in-lb)
- T4 : 9.8 N-m (1.0 kg-m, 7.0 ft-lb)
- T5 : 12 N-m (1.2 kg-m, 8.5 ft-lb)
- T6 : 25 N-m (2.5 kg-m, 18 ft-lb)
- T7 : 27 N-m (2.8 kg-m, 20 ft-lb)

- L : Apply a non-permanent locking agent to the threads.
- M : Apply molybdenum disulfide grease.
- SS: Apply silicone sealant to the threads.
- O : Apply oil.

## 4-4 ENGINE TOP END

### Specifications

Item	Standard	Service Limit
<b>Camshaft:</b>		
Cam height:		
Inlet	31.778 ~ 31.918 mm	31.68 mm
Exhaust	31.469 ~ 31.609 mm	31.37 mm
Camshaft, camshaft cap clearance:		
A	0.028 ~ 0.071 mm	0.16 mm
B	0.078 ~ 0.121 mm	0.21 mm
Camshaft journal diameter:		
A	23.950 ~ 23.972 mm	23.92 mm
B	23.900 ~ 23.922 mm	23.87 mm
Camshaft bearing inside diameter	24.000 ~ 24.021 mm	24.08 mm
Camshaft runout	---	0.1 mm TIR
Camshaft chain 20-link length	127.0 ~ 127.4 mm	128.9 mm
<b>Cylinder Head:</b>		
Cylinder compression (Usable range)	686 ~ 1 079 kPa (7.0 ~ 11.0 kg/cm <sup>2</sup> , 99 ~ 156 psi) @330 r/min (rpm)	
Cylinder head warp	---	0.05 mm
<b>Valves:</b>		
Valve clearance:		
Inlet	0.12 ~ 0.17 mm	---
Exhaust	0.16 ~ 0.21 mm	---
Valve spring free length	38.2 mm	36.4 mm
Valve head thickness:		
Inlet	0.5 mm	0.25 mm
Exhaust	0.7 mm	0.35 mm
Valve stem bend	0.02 mm TIR or under	0.05 mm TIR
Valve seat cutting angle	45°, 32°, 60°	---
Valve seating surface:		
Width:		
Inlet	0.5 ~ 1.0 mm	---
Exhaust	0.5 ~ 1.0 mm	---
Outside diameter:		
Inlet	21.5 ~ 21.7 mm	---
Exhaust	18.5 ~ 18.7 mm	---
Valve/valve guide clearance (wobble method):		
Inlet	0.031 ~ 0.140 mm	0.34 mm
Exhaust	0.085 ~ 0.180 mm	0.41 mm

Camshaft Height Measurement

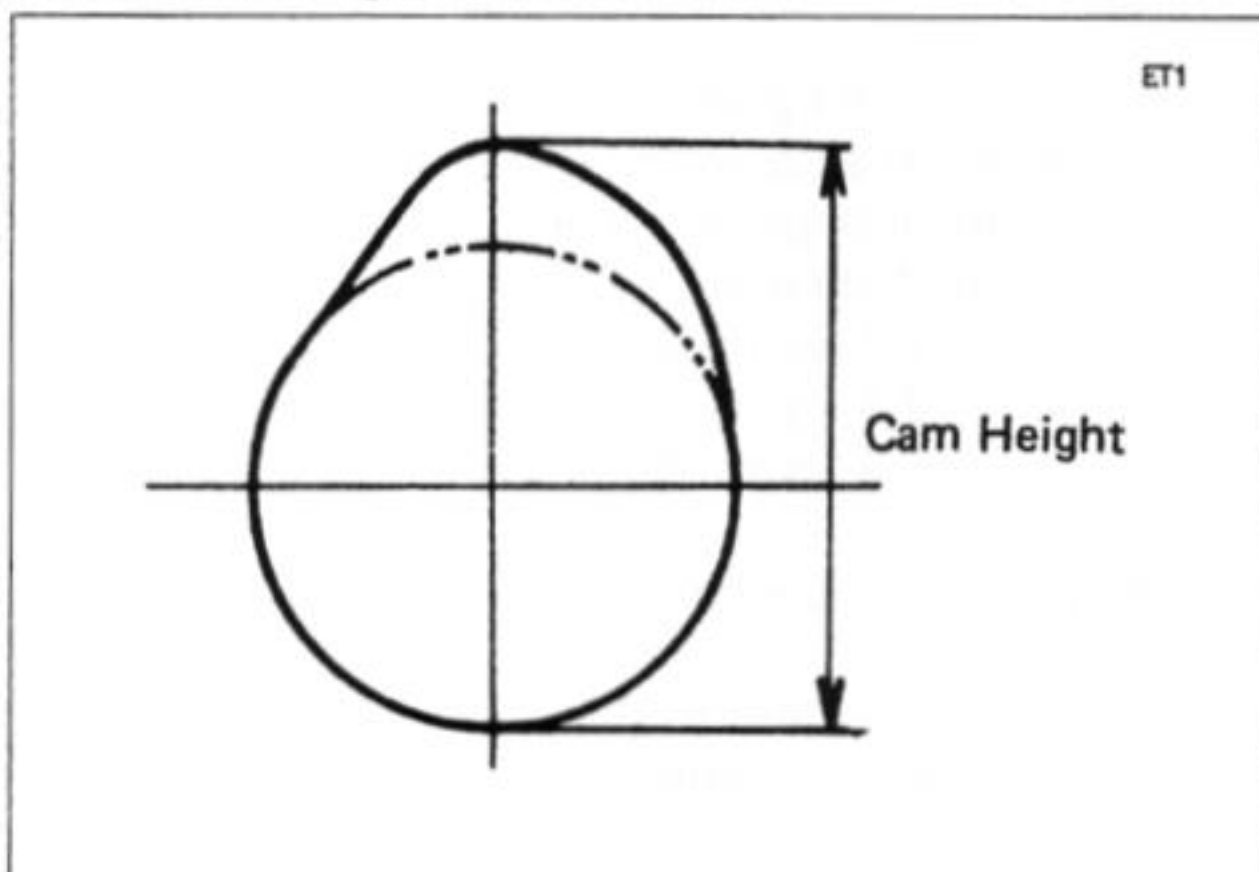

Camshaft Journal Diameter

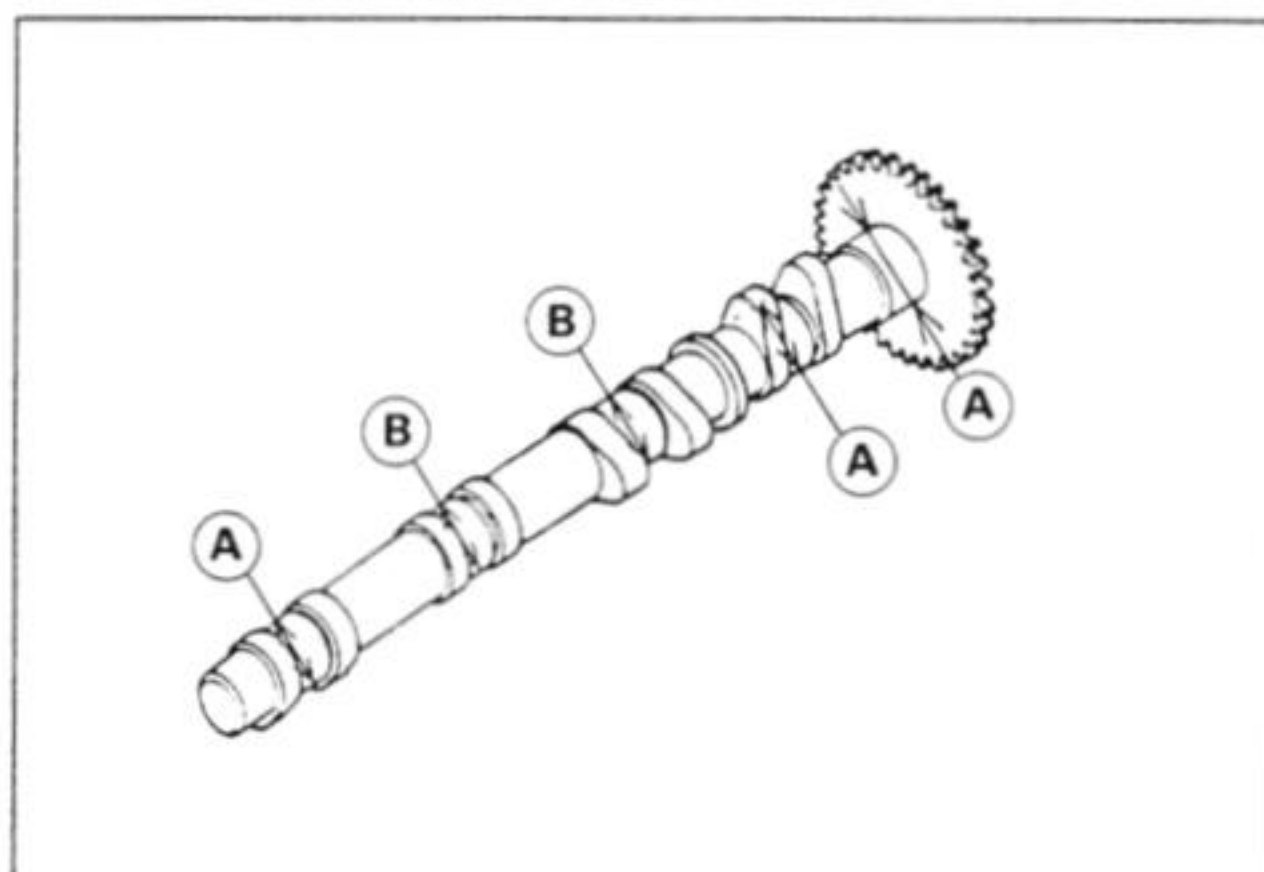

Item		Standard	Service Limit
Valve stem diameter:	Inlet	3.975 ~ 3.990 mm	3.96 mm
	Exhaust	3.955 ~ 3.970 mm	3.94 mm
Valve guide inside diameter		4.000 ~ 4.012 mm	4.08 mm
<b>Cylinder, Piston:</b>			
Cylinder inside diameter		57.000 ~ 57.012 mm	57.10 mm
Piston diameter		56.942 ~ 56.957 mm	56.79 mm
Piston/cylinder clearance		0.043 ~ 0.070 mm	- - -
Oversize piston and rings		+ 0.5 mm	- - -
Piston ring/groove clearance		0.030 ~ 0.070 mm	0.17 mm
Piston ring end gap:	Top	0.15 ~ 0.30 mm	0.6 mm
	Second	0.35 ~ 0.50 mm	0.8 mm

Valve Head

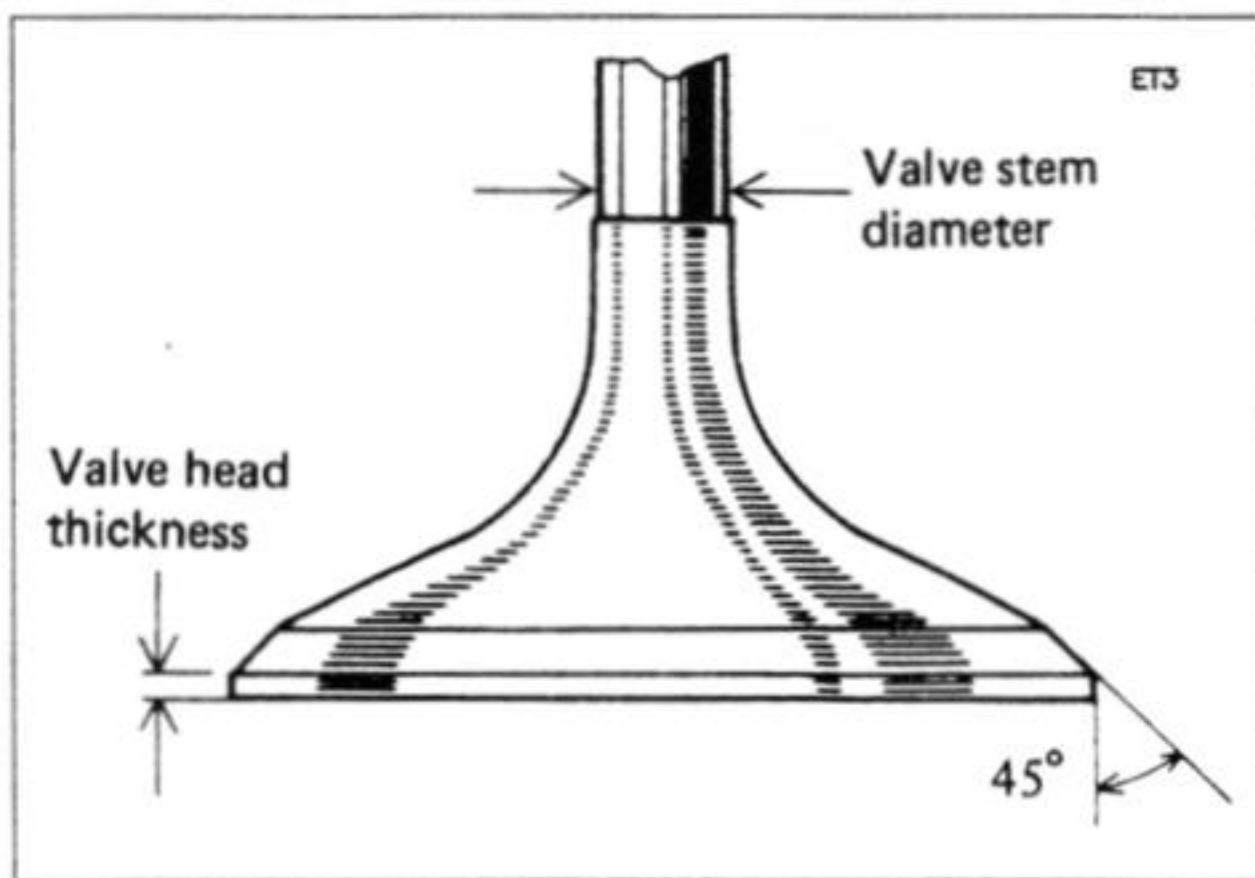

Valve Stem Bend

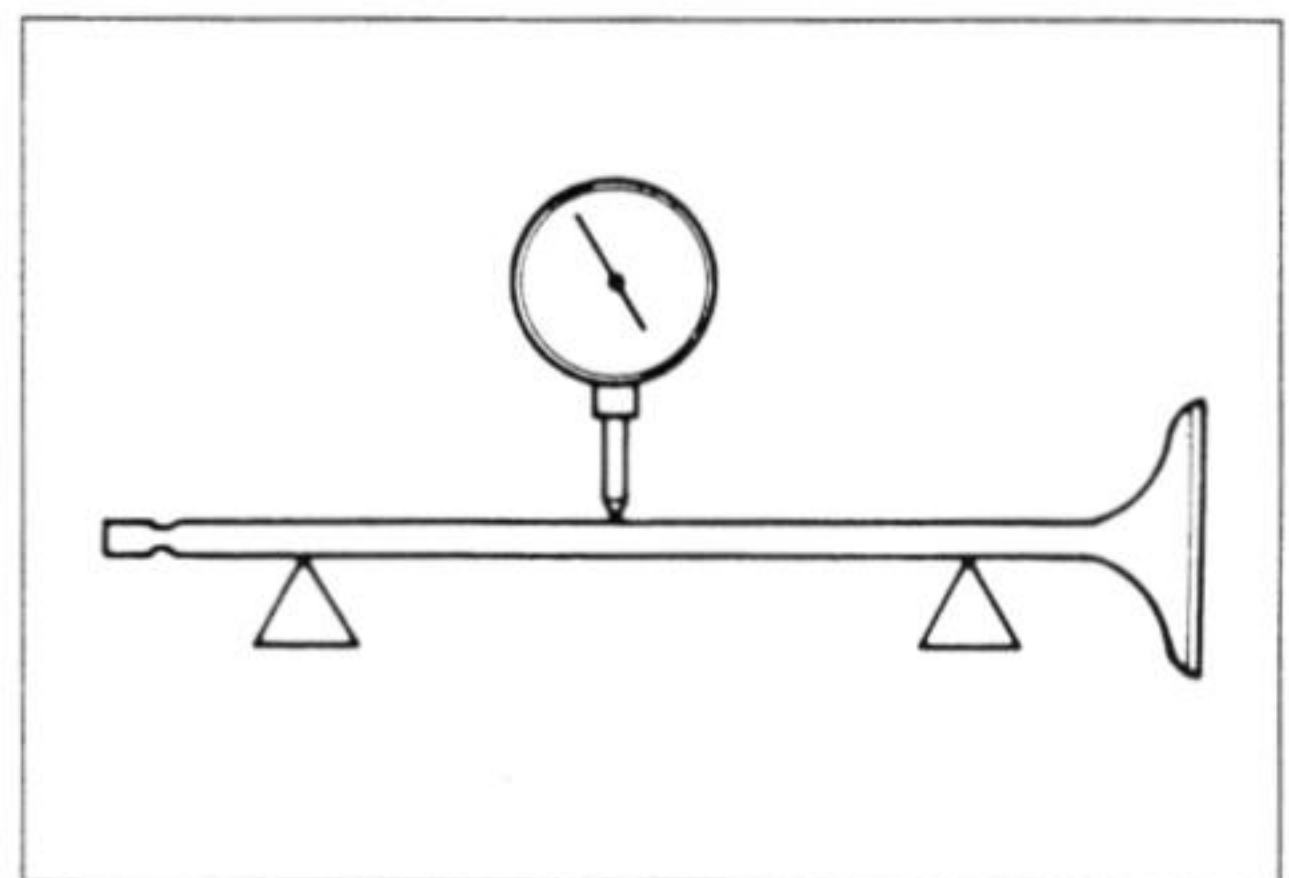

Camshaft Runout

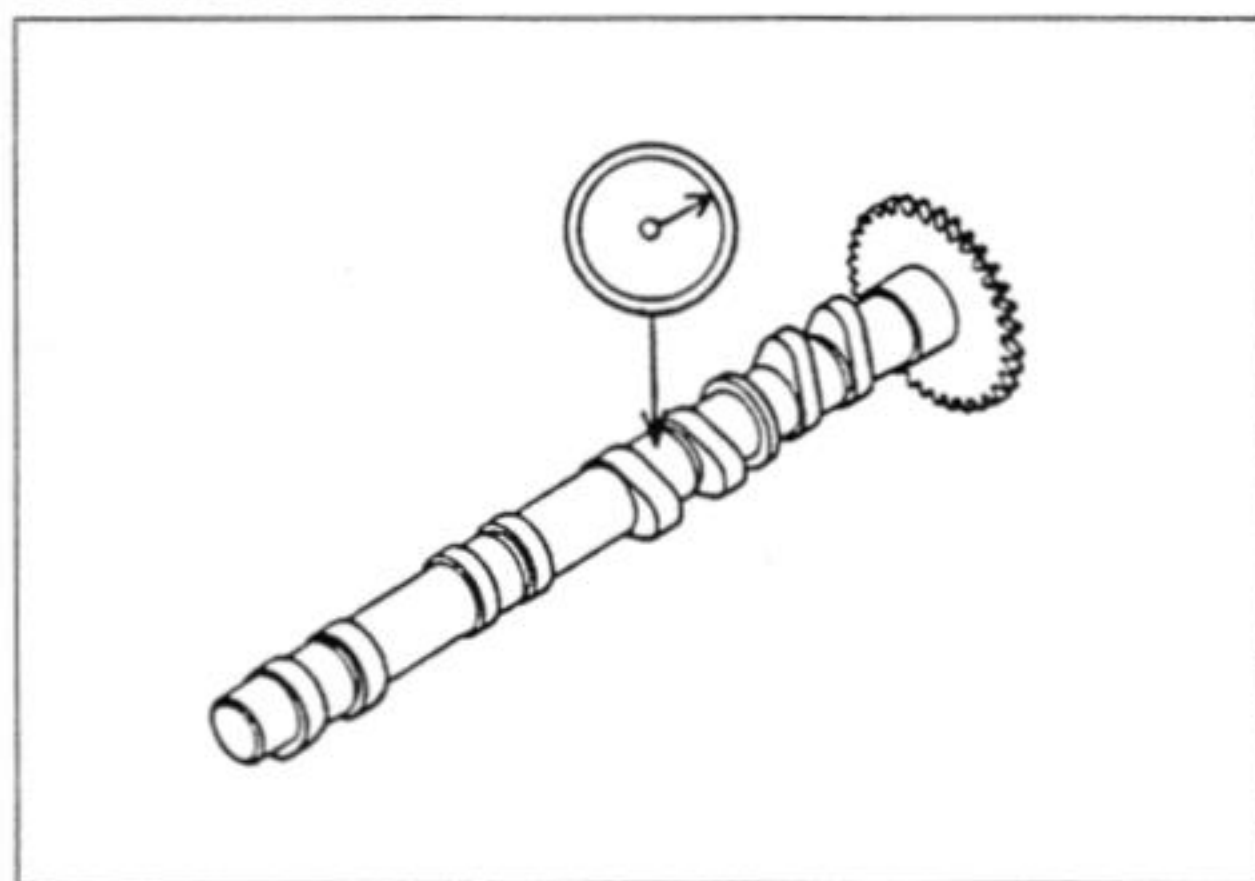

## 4-6 ENGINE TOP END

### Special Tools

Compression Gauge: 57001-221



Valve Spring Compressor Joint: 57001-1271

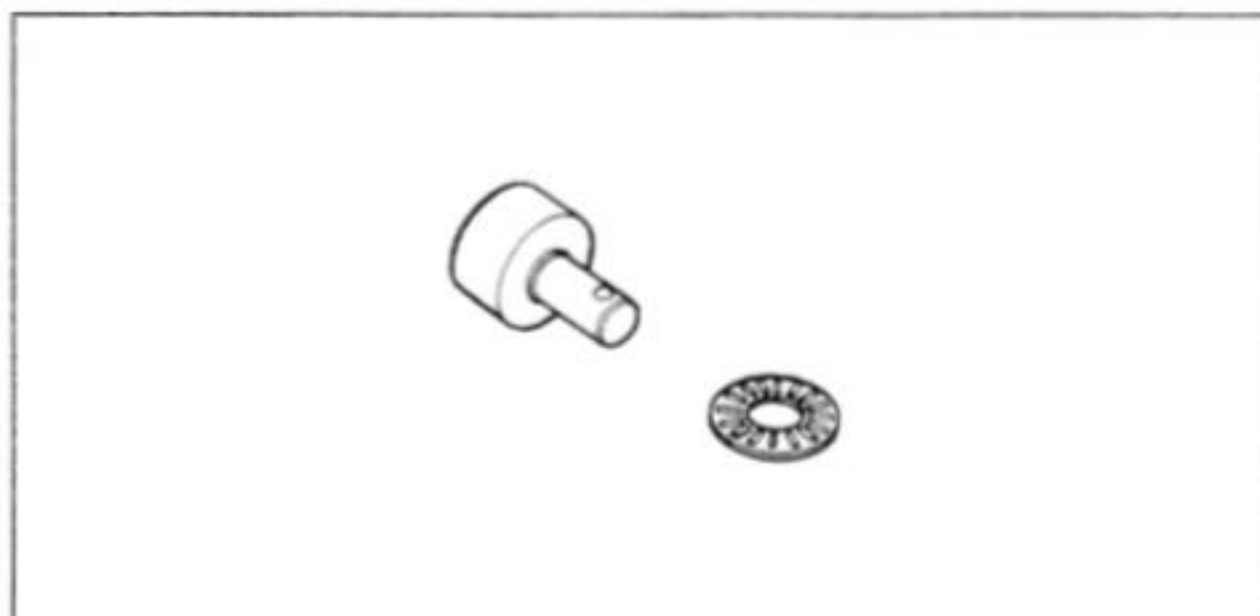

Compression Gauge Adapter, M10 X 1.0: 57001-1317

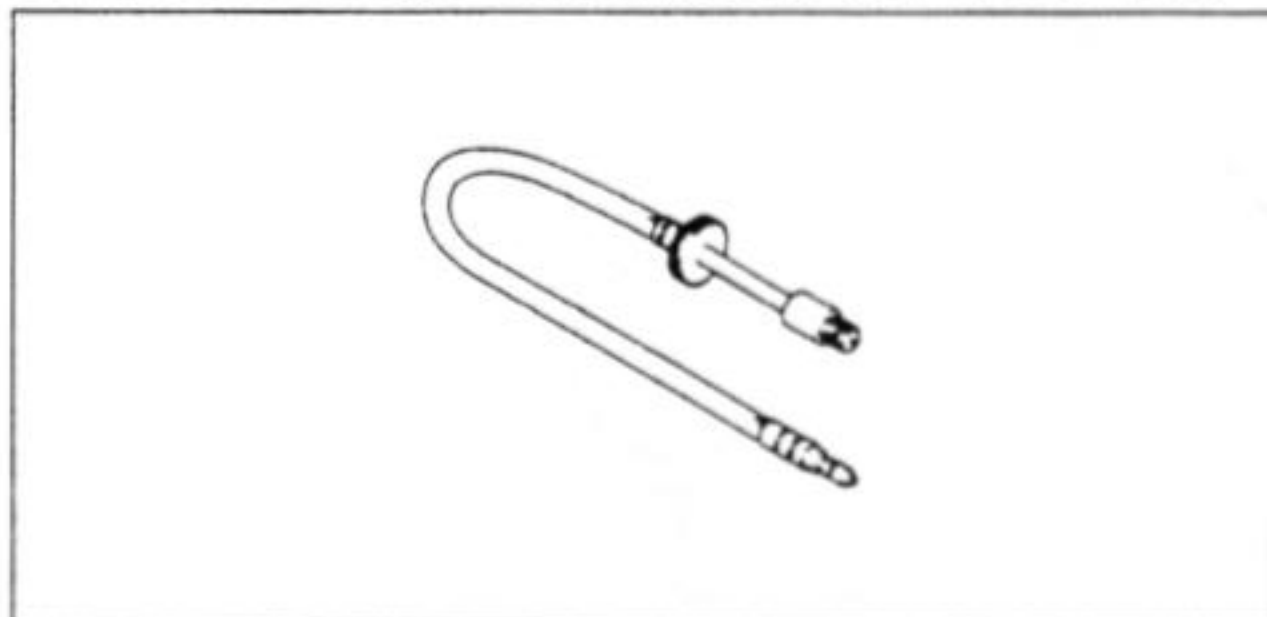

Valve Guide Arbor,  $\Phi 4$ : 57001-1273



Rocker Arm Holder: 57001-1270

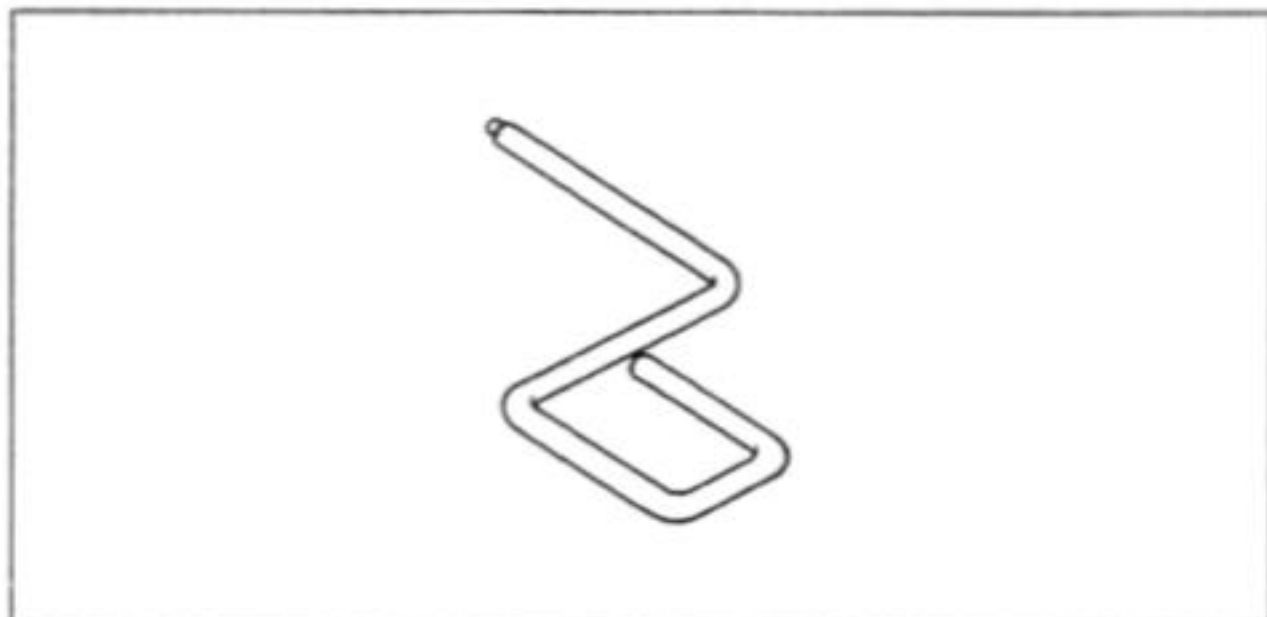

Valve Guide Reamer,  $\Phi 4$ : 57001-1274



Valve Spring Compressor Assembly: 57001-241

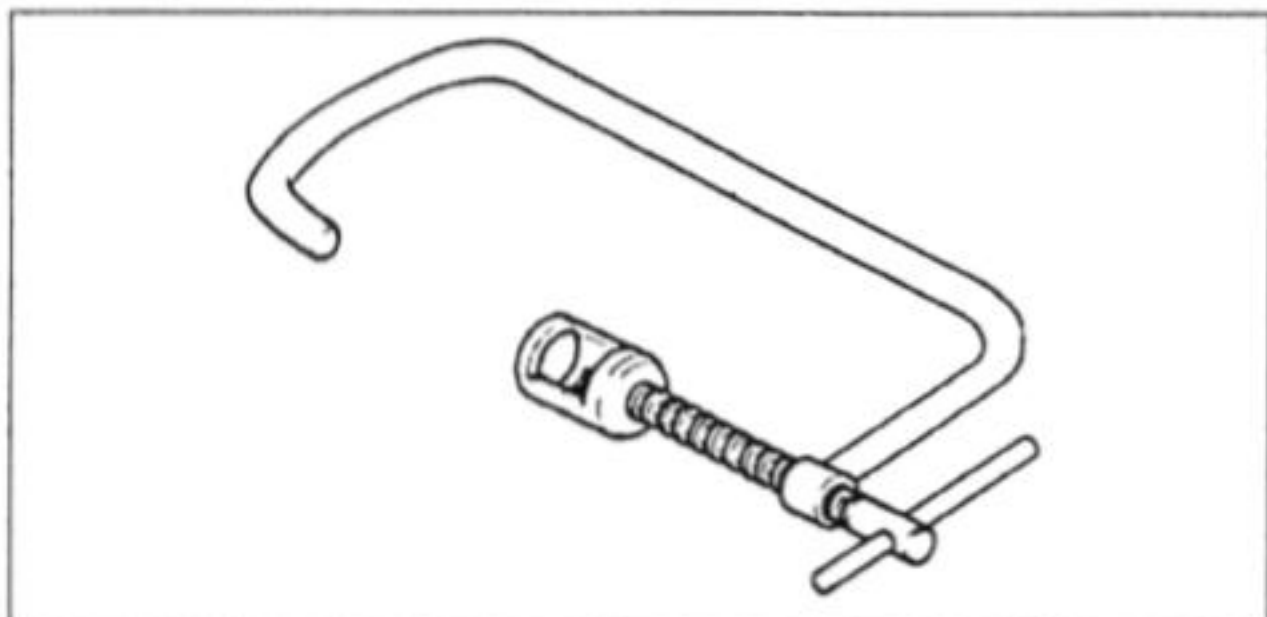

Valve Seat Cutter Holder,  $\Phi 4$ : 57001-1275

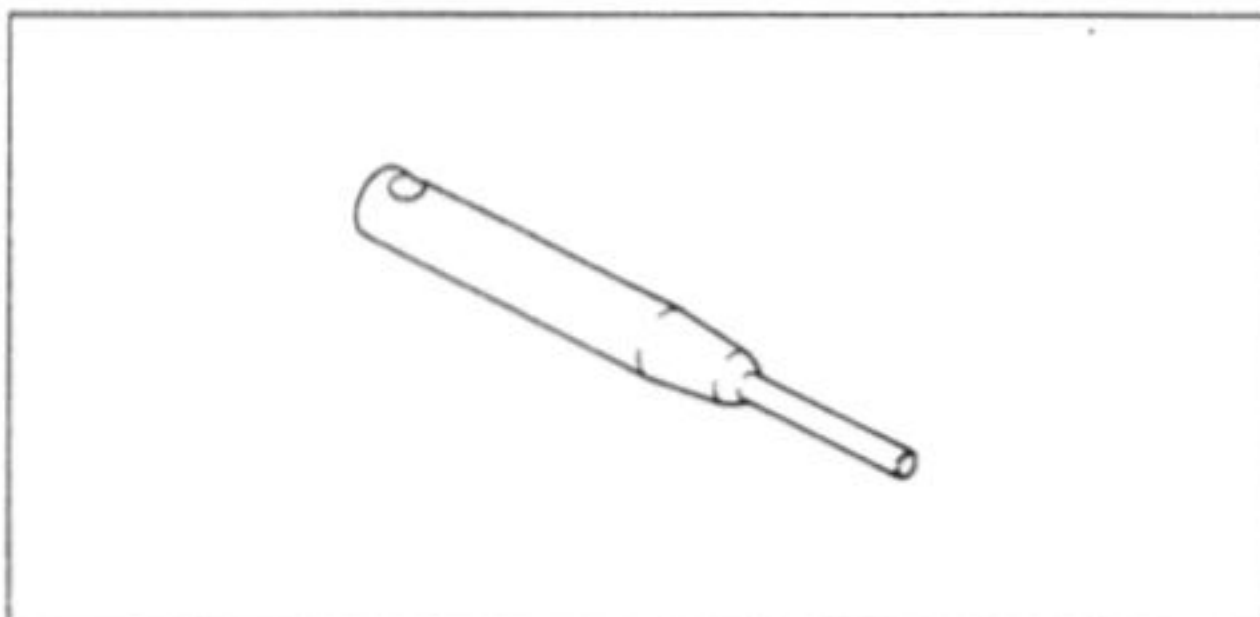

Valve Spring Compressor Adapter,  $\Phi 21$ : 57001-1272

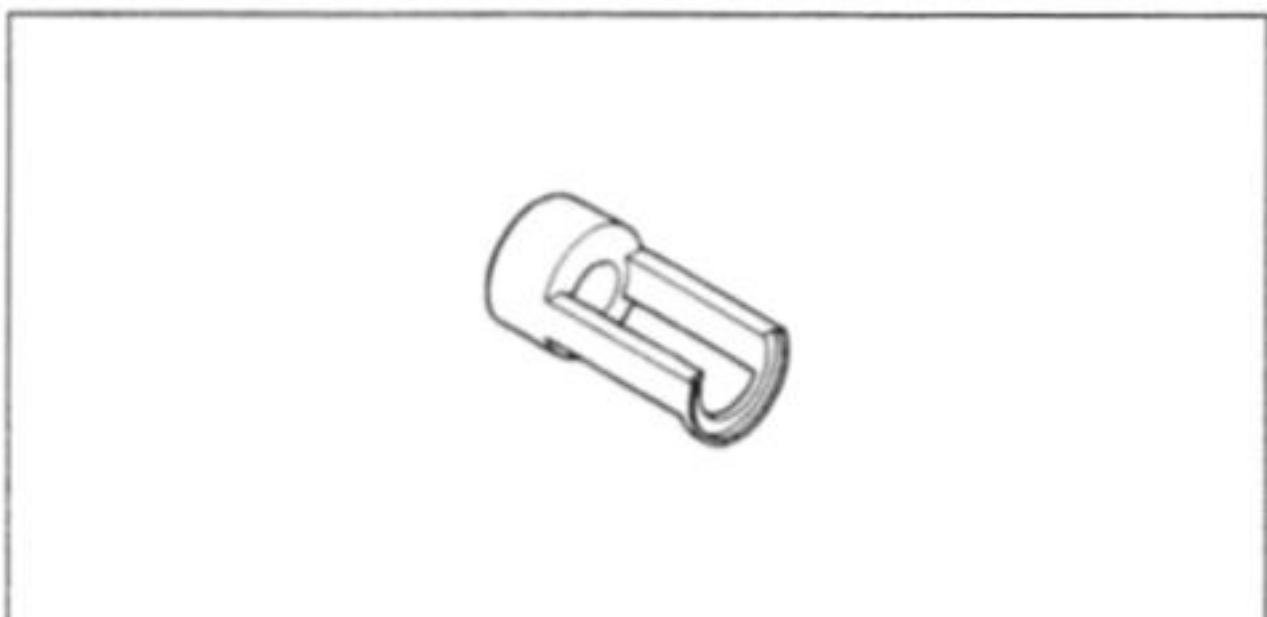

Valve Seat Cutter,  $45^\circ - \Phi 20.5$ : 57001-1307

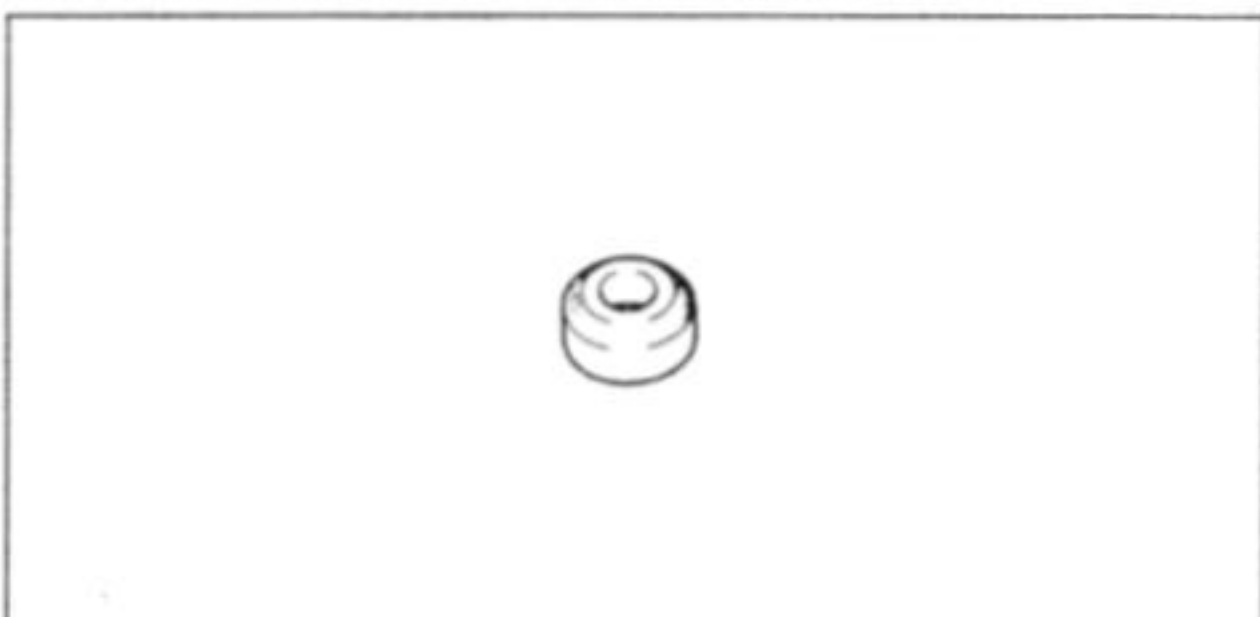

Valve Seat Cutter, 30° -  $\phi$ 18: 57001-1308

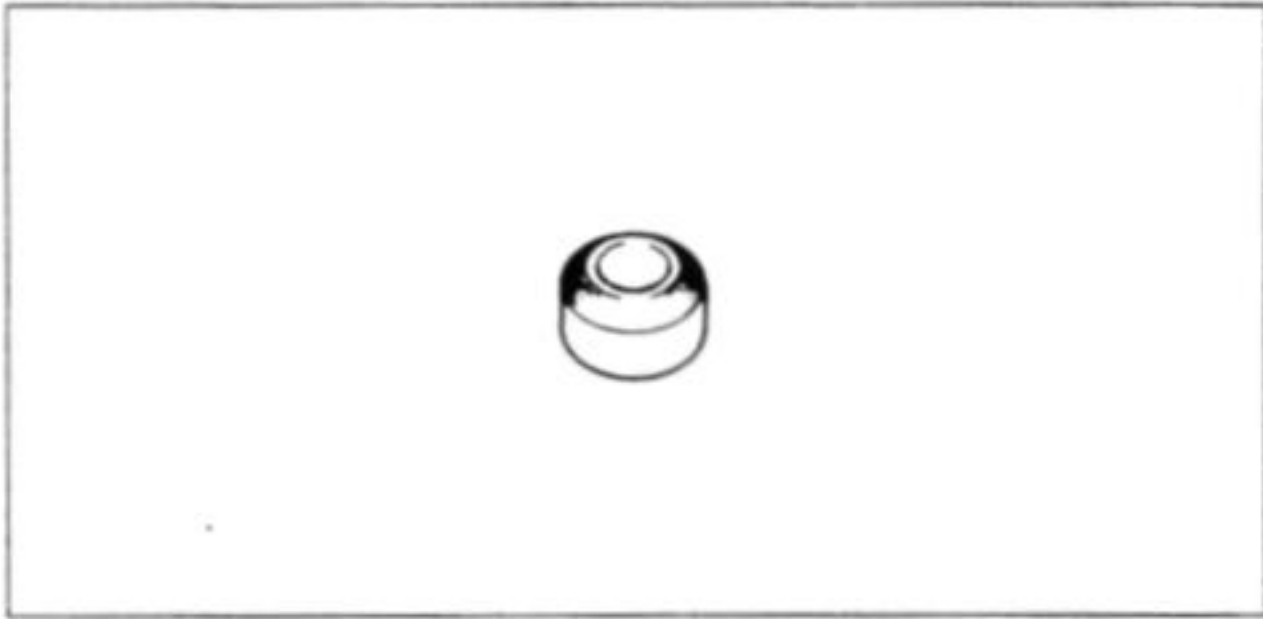

Valve Seat Cutter, 65° -  $\phi$ 19: 57001-1310

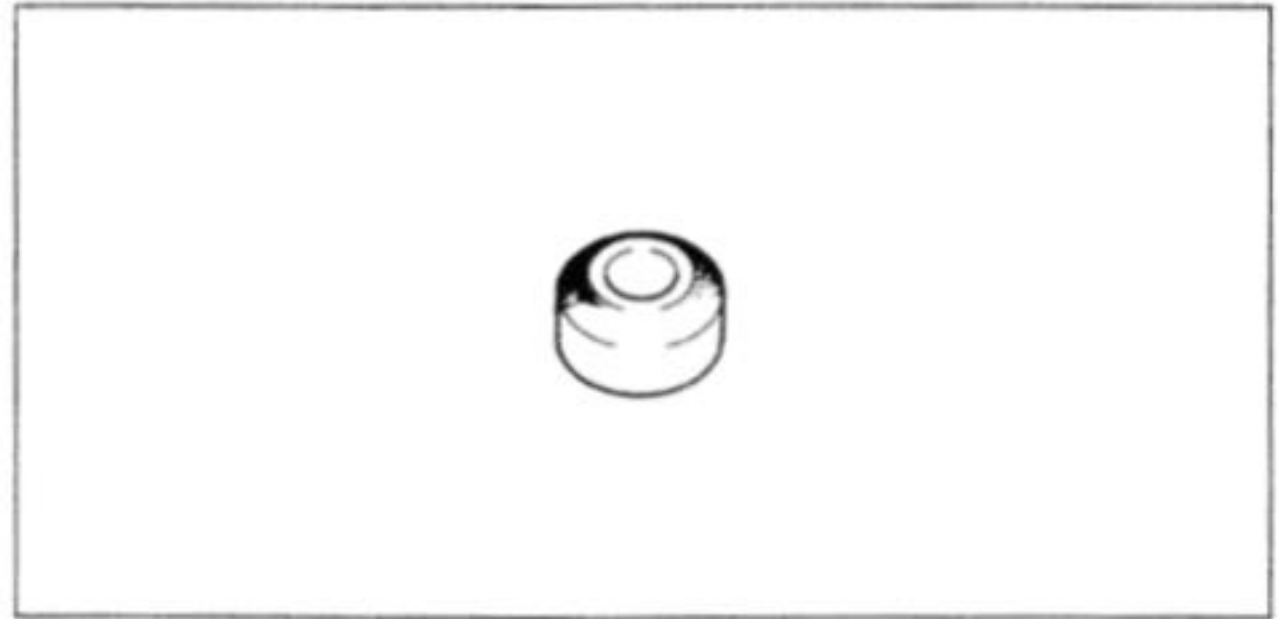

Valve Seat Cutter Holder Bar: 57001-1128

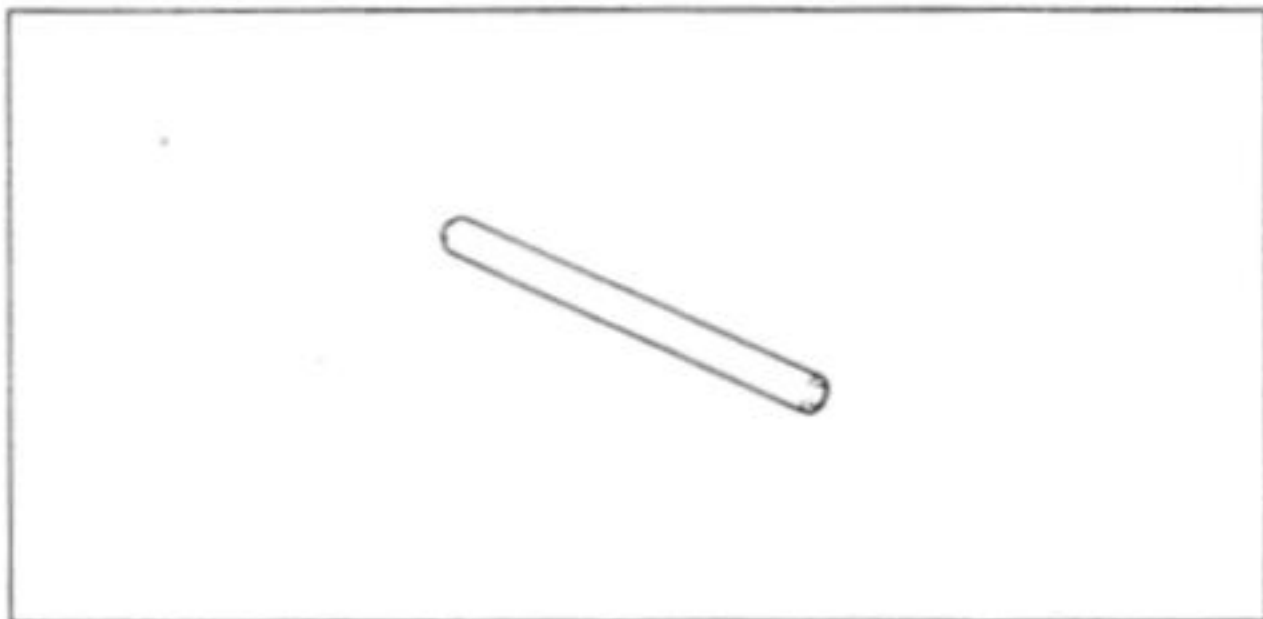

Piston Base,  $\phi$ 8: 57001-147

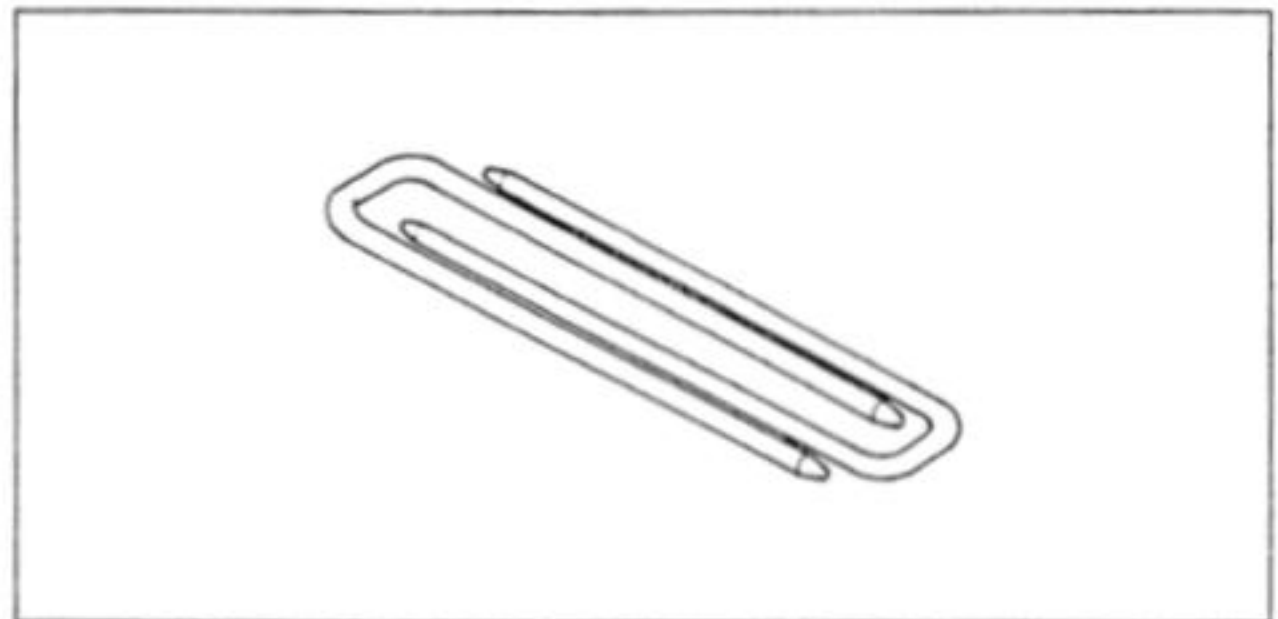

Valve Seat Cutter, 60° -  $\phi$ 25: 57001-1328

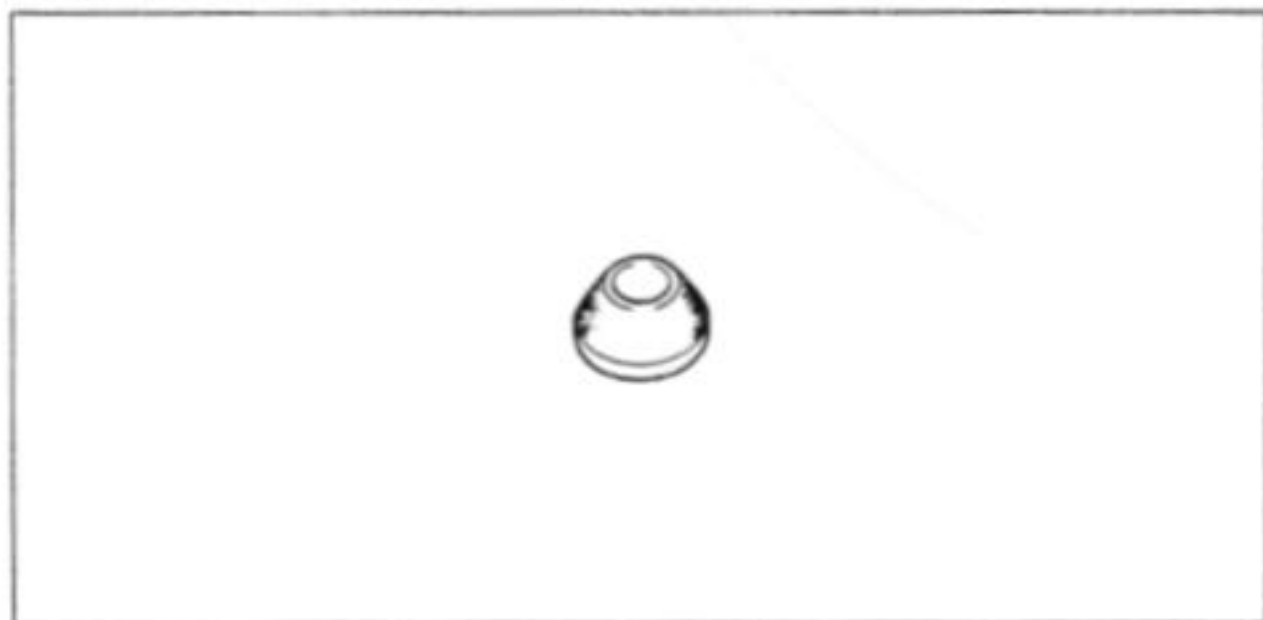

Piston Pin Puller Assembly: 57001-910

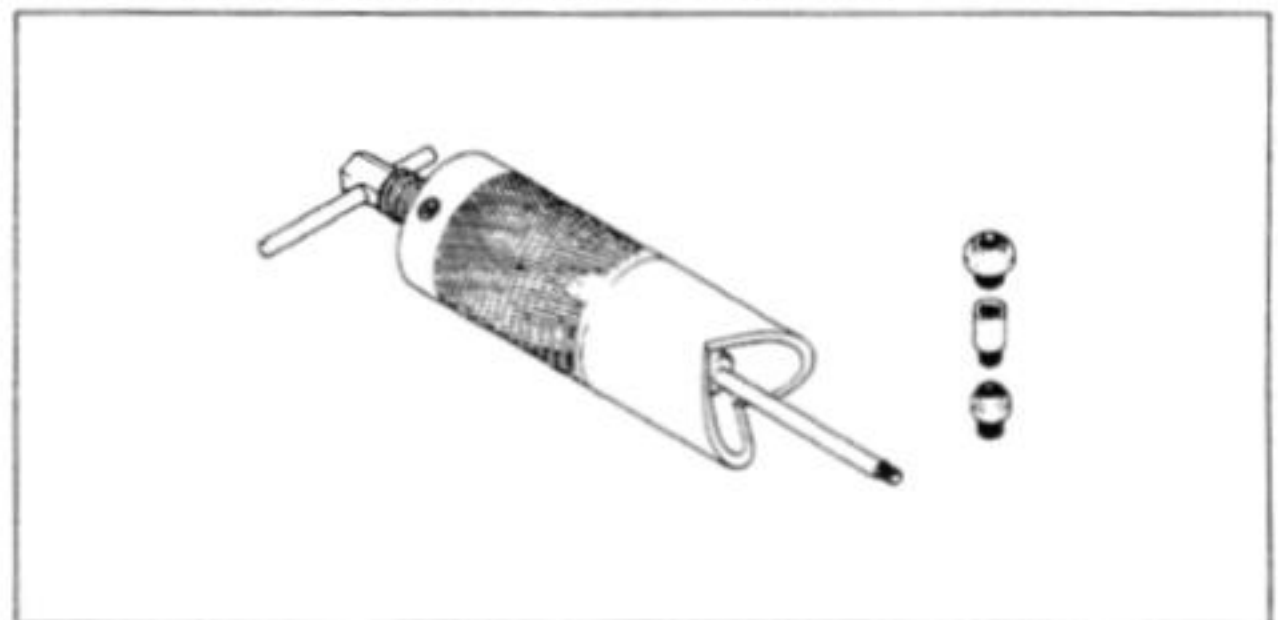

Valve Seat Cutter, 45° -  $\phi$ 22: 57001-1205

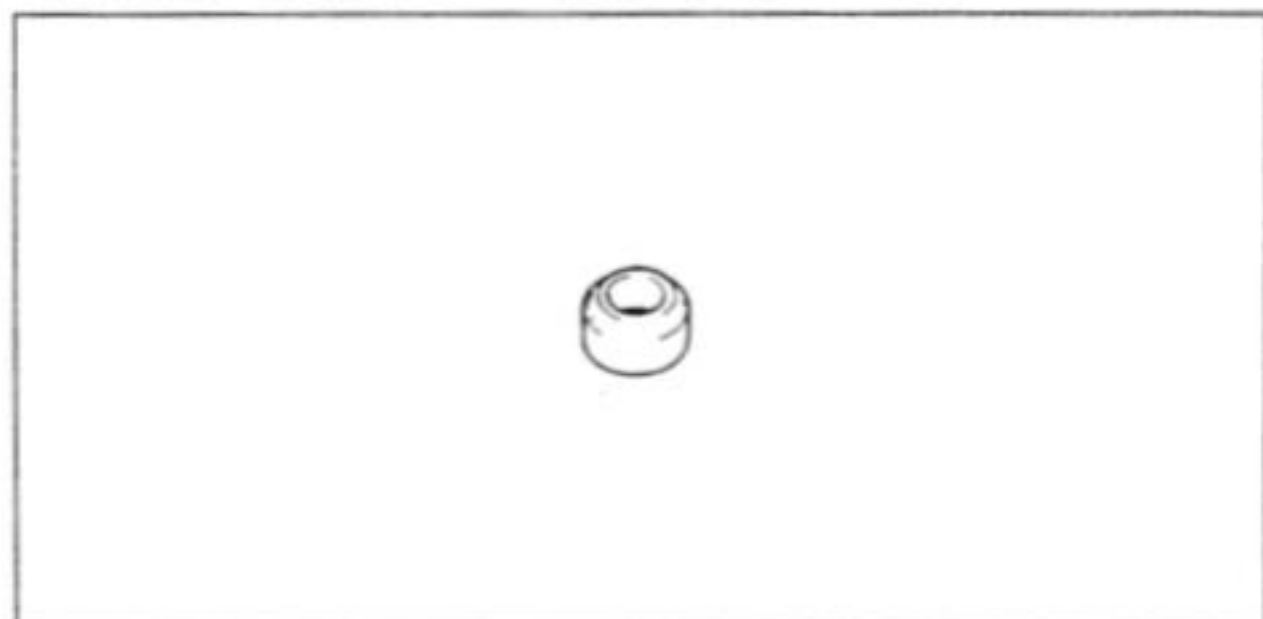

---

## Sealant

---

Kawasaki Bond (Silicone Sealant): 56019-120

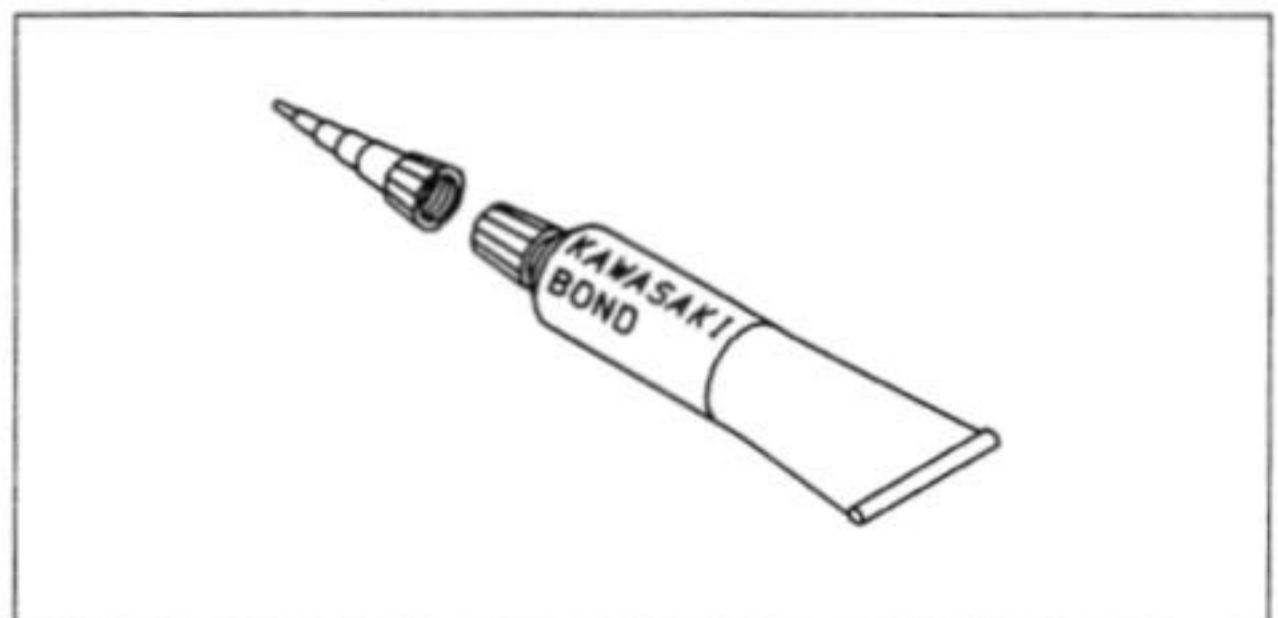

Valve Seat Cutter, 32° -  $\phi$ 22: 57001-1206

